

For Years! I called this the Texas Patent... I mistakenly mapped this next to William Anderson's patent at Falling Run creek and began building out as many patents as I could find to gather all the clues I could to figure out the neighbors of my ancestors.

If you run across any of my early renditions of this area of Swift Creek in Edgecombe County... try not to laugh... a smile is quite warranted however.

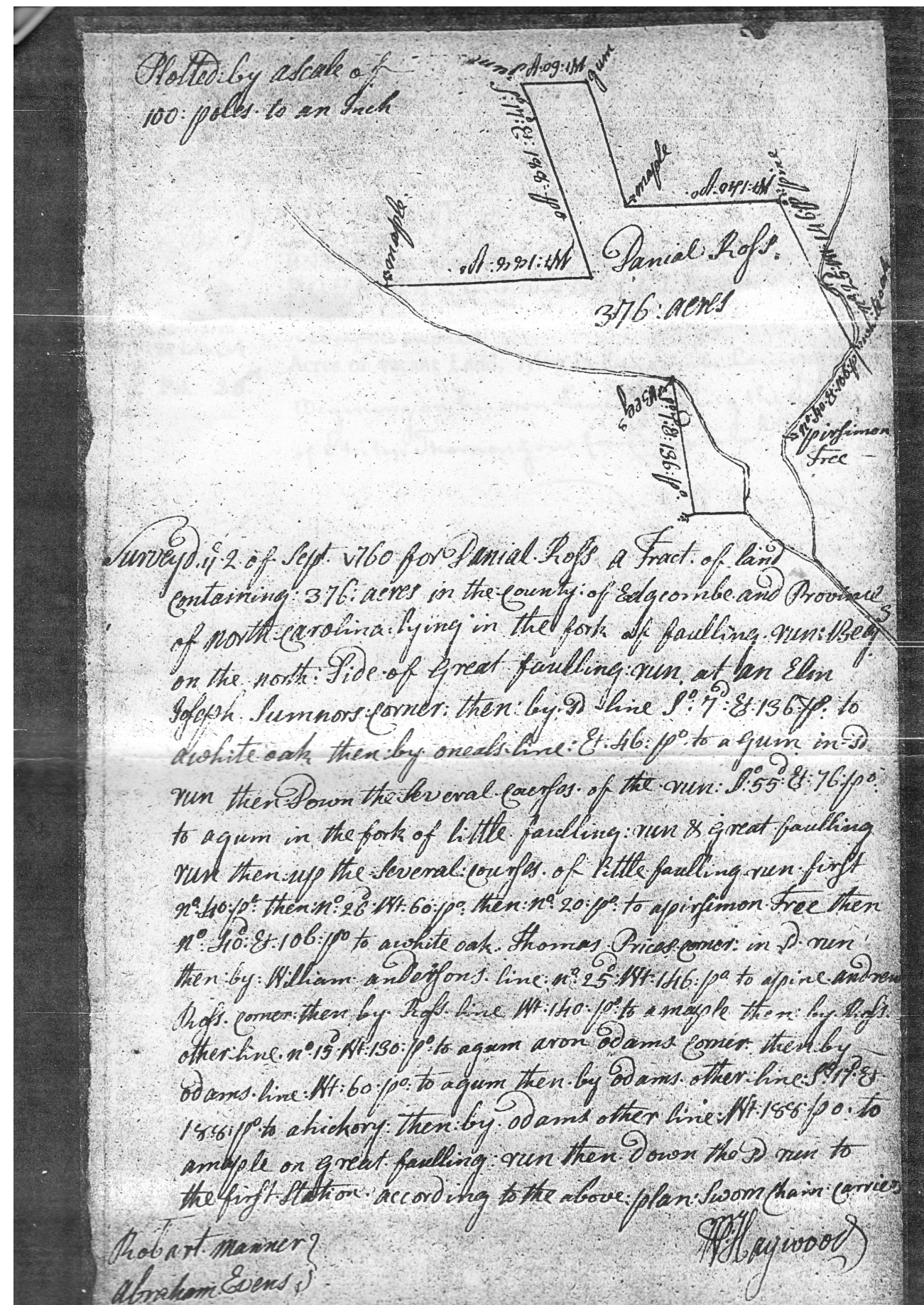

North-Carolina,

THOMAS CHILD, Esquire, special Agent and Commissioner to the Right Honorable THE EARL GRANVILLE, sole Lord or Proprietor of a certain District, Territory, or Parcel of Land, lying in the said Province.

TO Mr. William Hupwood His Lordship's Surveyor for the County of Edgecombe Greeting :

YOU are forthwith to admeasure and lay out to Daniel Proff a Tract of vacant Land, containing Six hundred & forty Acres, lying in Edgecombe County, within the said District on the North Side of Falling Run including the Vacant Land between the Lines of Thomas Price Pollard, Aaron Adams, Andrew Proff & William Anderson for Complaint.

REGISTERED IN LIB. 4 VOL. 7

OBSERVING my Instructions to you for running out Lands: THREE just and fair Plans whereof, certified under your Hand, with the Day of your making the same, you are to return to the Person mentioned in my said Instructions for receiving the same, within Six Months from the Date of this Warrant; IN ORDER that the said Daniel Proff may, within Twelve Months ensuing the Day of such your Survey, so to be returned as aforesaid, take out a Grant of the Lands therein contained, for completing his Title: OTHERWISE this Warrant to be void and of no Force; AND the said Lands to be deemed free, and at Liberty to be taken up by any other Person that shall apply to me for that Purpose. DATED the Third Day of March 1760

RETURNED, executed the Day of 17 By Order of the said Agent.

Mar 3, 1760

NC LAND GRANT IMAGES AND DATA

Edgecombe Co. File No. 1303, Sherwood Haywood Issued 15 Oct 1761 for 350 acres 'Lying on Dowhead Pocoson' Patent Book image; Loose Documents not linked to images

From PATENT BOOK Issued: 15 Oct 1761 County: Edgecombe Grant no.: 128 Book: 11 pg: 199

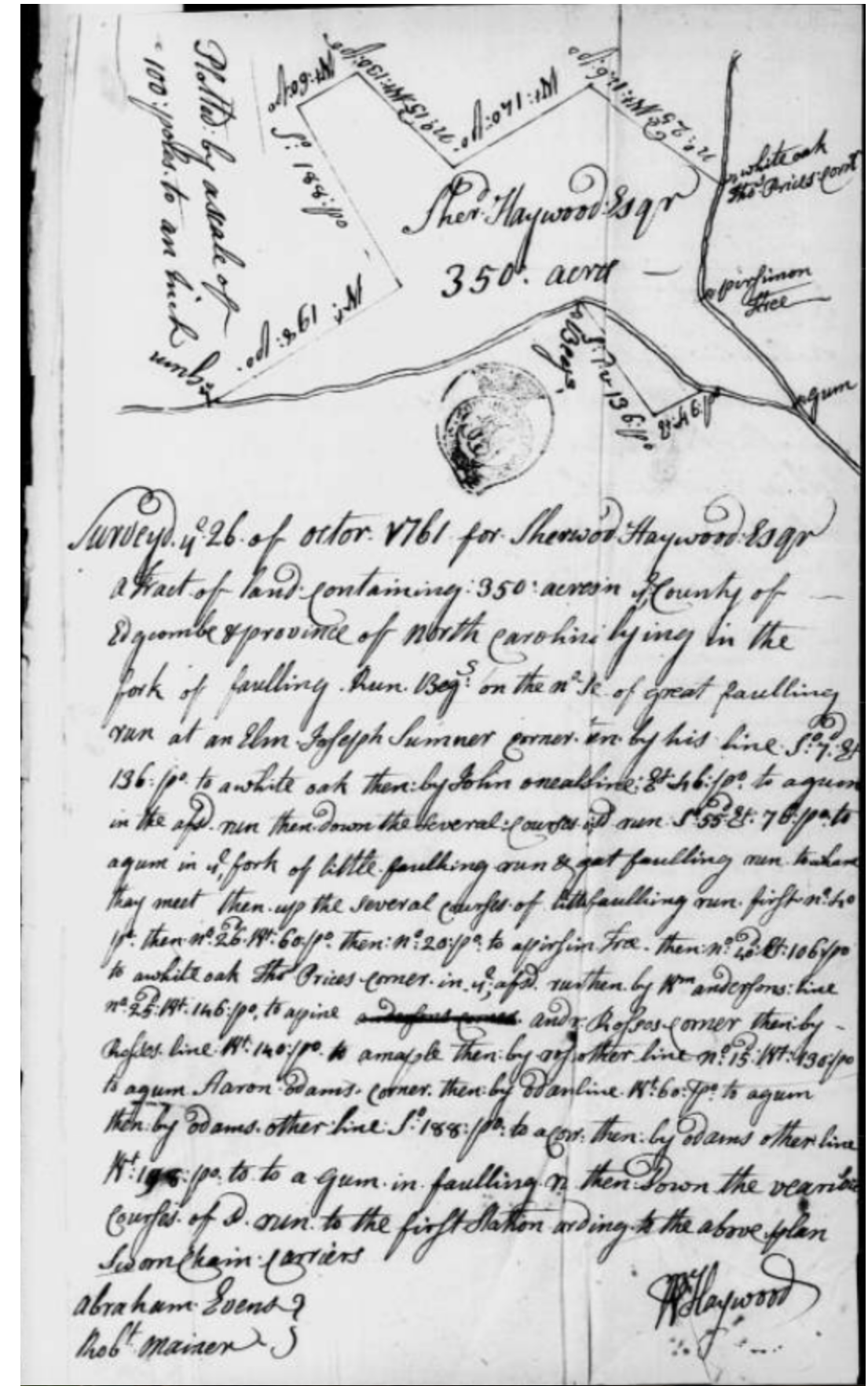

Edgecombe Issued: 15 Oct 1761 Book: 11 pg: 199 Grant no.: 128 File no.: 1303 MAPS: 12:14:59.1312

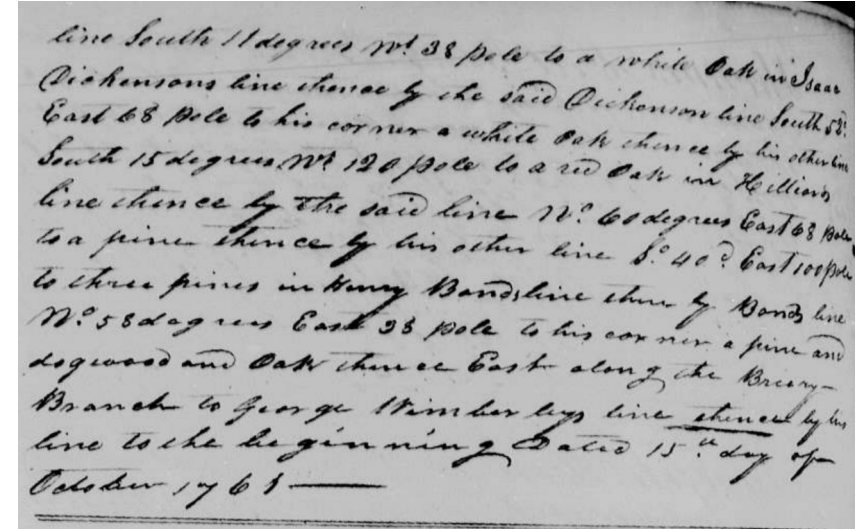
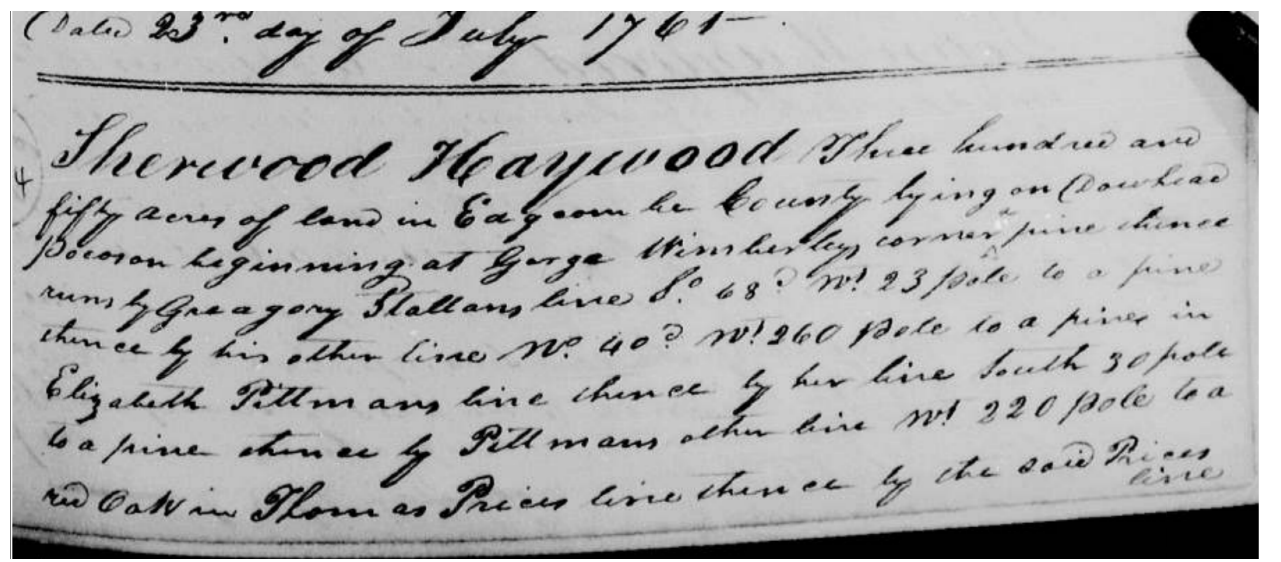

Sherwood Haywood 350 ac Edgecombe, Dowhead Pocoson begin x George Wimberley corner S 68 W 34 po Gregory Stallans line N 40 W 260 to Elizabeth Pittman line S 30 W 220 in Thomas Price line S 11 W 38 in Isaac Dickenson line S 52 E 68 to corner S 15 W 120 to Hilliard line N 60 E 68 S 40 E 100 to Henry Bond line N 58 E 28 E along Briary Branch to George Wimberley line then to 1st 1761

After all the fuss... this is the final patent issued... I think

