

1819 Commissioners divide the lands of Joseph Pitt dec'd

Edge. Co. Db 16, page 376, deed date 14 Aug 1819, recorded Aug Ct 1819, Willis Pitt, Edge. Co to Joseph Lackey, same county for \$800, all his right title and claim to a tract containing (73) acres which said tract descended to the said Willis Pitt as one of the heirs of the late **Joseph Pitt dec'd, bounded by the lands of Archibald Pitt, John Griffin, the orphans of James Perry and**

FamilySearch Family Tree Search Menu

← Edgcombe, Deeds 1819-1823

Image 1 of 590

Citation

"Edgcombe, North Carolina, United States records," images, FamilySearch (https://www.familysearch.org/ark:/61903/3:1:3Q9M-CSK7-9986-52247?i=9986&cat=2026), image 63 of 590. Image Group Number: 007513474

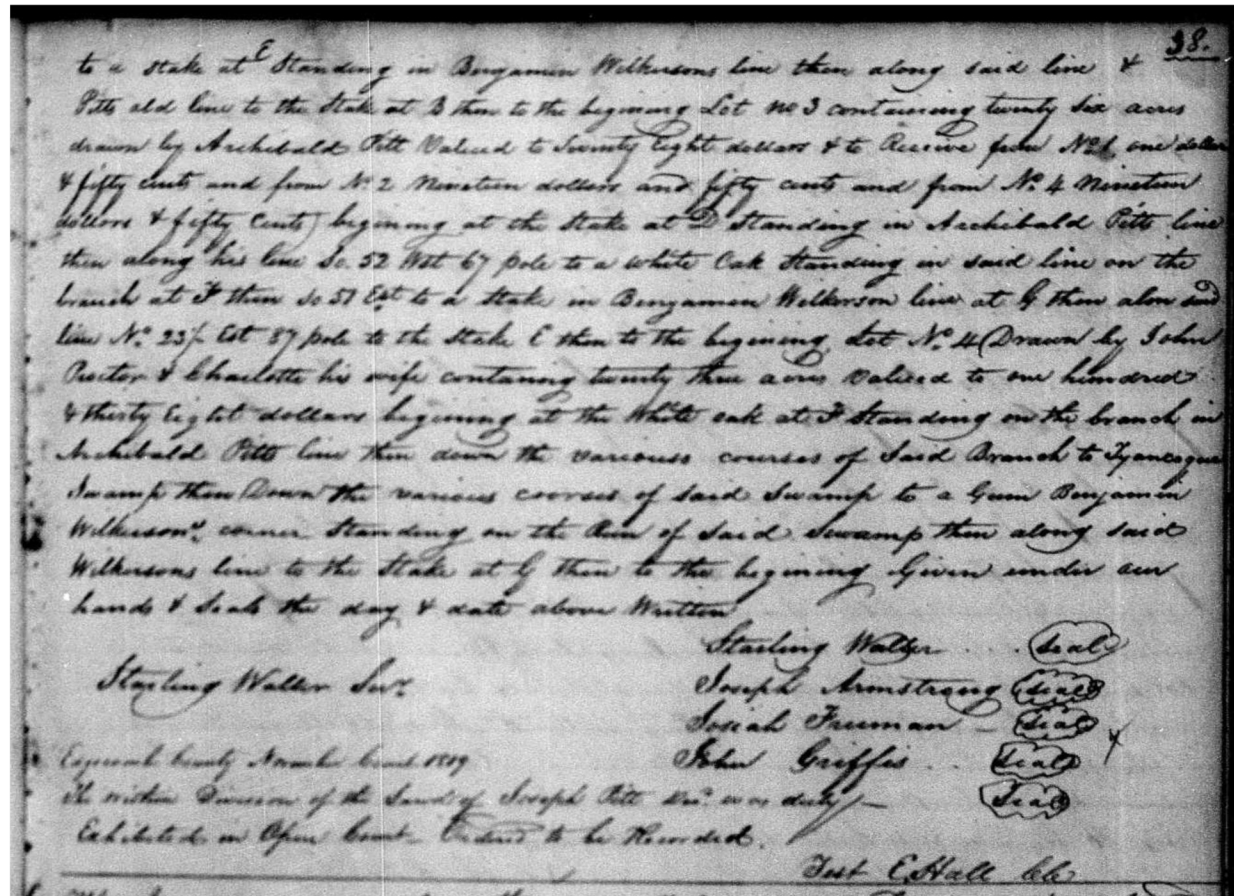
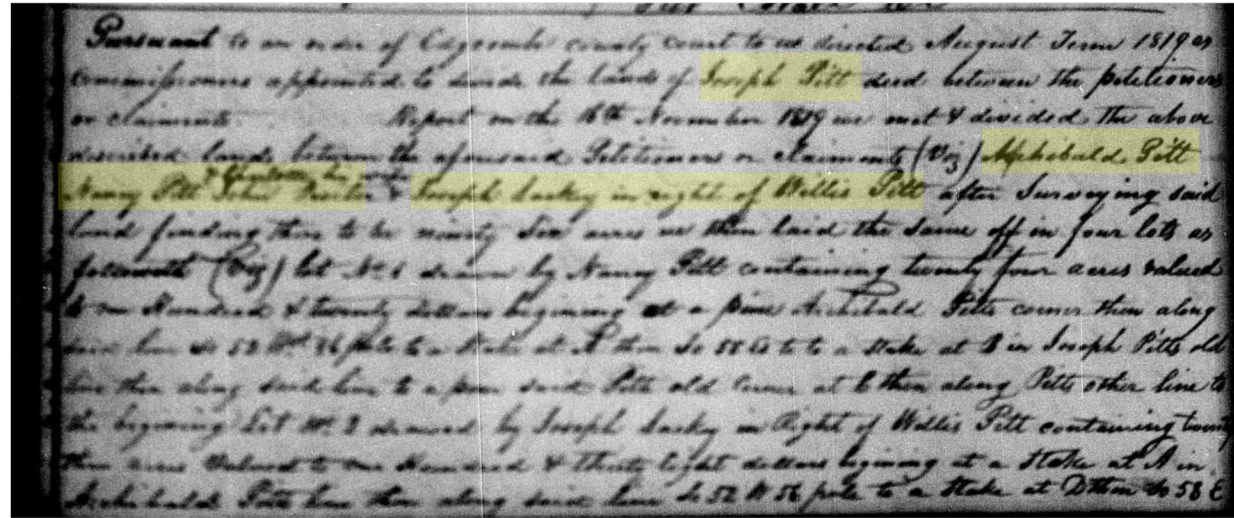

Edge. Co. Db 17, page 37, deed date 16 Nov 1819, recorded Nov Ct 1819, by order of Aug Ct 1819 commissioners divide the lands of Joseph Pitt dec'd between the petitioners or claimants, viz Archibald Pitt Nancy Pitt, John Proctor & Charlotte his wife, Joseph Lackey in right of Willis Pitt, tract of 96 acres divided as follows: lot #1 to Nancy Pitt containing 24 acres valued at \$120 beginning at a pine Archibald Pitt's corner then along said line south 52 west 86 poles to a stake at "A" then south 58 east to a stake at "B" in Joseph Pitt's old line then along said line to a pine said Pitt's old corner at "C" then along Pitt's other line to the beginning; lot #2 to Joseph Lackey in right of Willis Pitt containing 23 acres valued at \$138 beginning at a stake at "A" in Archibald Pitt's line then along said line south 52 west 56 poles to a stake at "D" then south 58 east to a stake at "E" standing in Benjamin Wilkinson's line then along said line & Pitt's old line to the stake at "B" then to the beginning; Lot #3 containing 26 acres valued at \$78 and to received from #1 \$1, from lot #2 \$19.50 and from lot #4 \$19.50, beginning at the stake at "D" standing in Archibald Pitt's line then along his line south 52 west 67 poles to a white oak standing in said line on the branch at "F" then south 51 east to a stake in Benjamin Wilkinson line at "G" then along said line north 23 1/2 east to the stake at "E" then to the beginning; lot #4 to John Proctor & Charlotte his wife containing 23 acres valued at \$138 beginning at the white oak at "F" standing on the branch in Archibald Pitt's line then down the various courses of said branch to Tyan Cokey Swamp then down the various courses of said swamp to a gum Benjamin Wilkinson's corner standing on the run of said swamp then along said Wilkinson's line to the stake at "G" then to the beginning, signed Starling Waller, Joseph Armstrong, Josiah Freeman, John Griffin, Starling Waller, Sur. Abstracted 29 Apr 07, NCA film C.037.40015 CTC.

lot #1 to Nancy Pitt
containing 24 acres valued at \$120 beginning at a pine Archibald Pitt's corner then along said line south 52 west 86 poles to a stake at "A" then south 58 east to a stake at "B" in Joseph Pitt's old line then along said line to a pine said Pitt's old corner at "C" then along Pitt's other line to the beginning;

lot #2 to Joseph Lackey in right of Willis Pitt containing 23 acres valued at \$138 beginning at a stake at "A" in Archibald Pitt's line then along said line south 52 west 56 poles to a stake at "D" then south 58 east to a stake at "E" standing in Benjamin Wilkinson's line then along said line & Pitt's old line to the stake at "B" then to the beginning;

Lot #3 containing 26 acres valued at \$78 and to received from #1 \$1, from lot #2 \$19.50 and from lot

lot #4 \$19.50, beginning at the stake at "D" standing in Archibald Pitt's line then along his line south 52 west 67 poles to a white oak standing in said line on the branch at "F" then south 51 east to a stake in Benjamin Wilkinson line at "G" then along said line north 23 1/2 east to the stake at "E" then to the beginning;

lot #4 to John Proctor & Charlotte his wife containing 23 acres valued at \$138 beginning at the white oak at "F" standing on the branch in Archibald Pitt's line then down the various courses of said branch to Tyan Cokey Swamp then down the various courses of said swamp to a gum Benjamin Wilkinson's corner standing on the run of said swamp then along said Wilkinson's line to the stake at "G" then to the beginning

24
23
26
23
96 acres

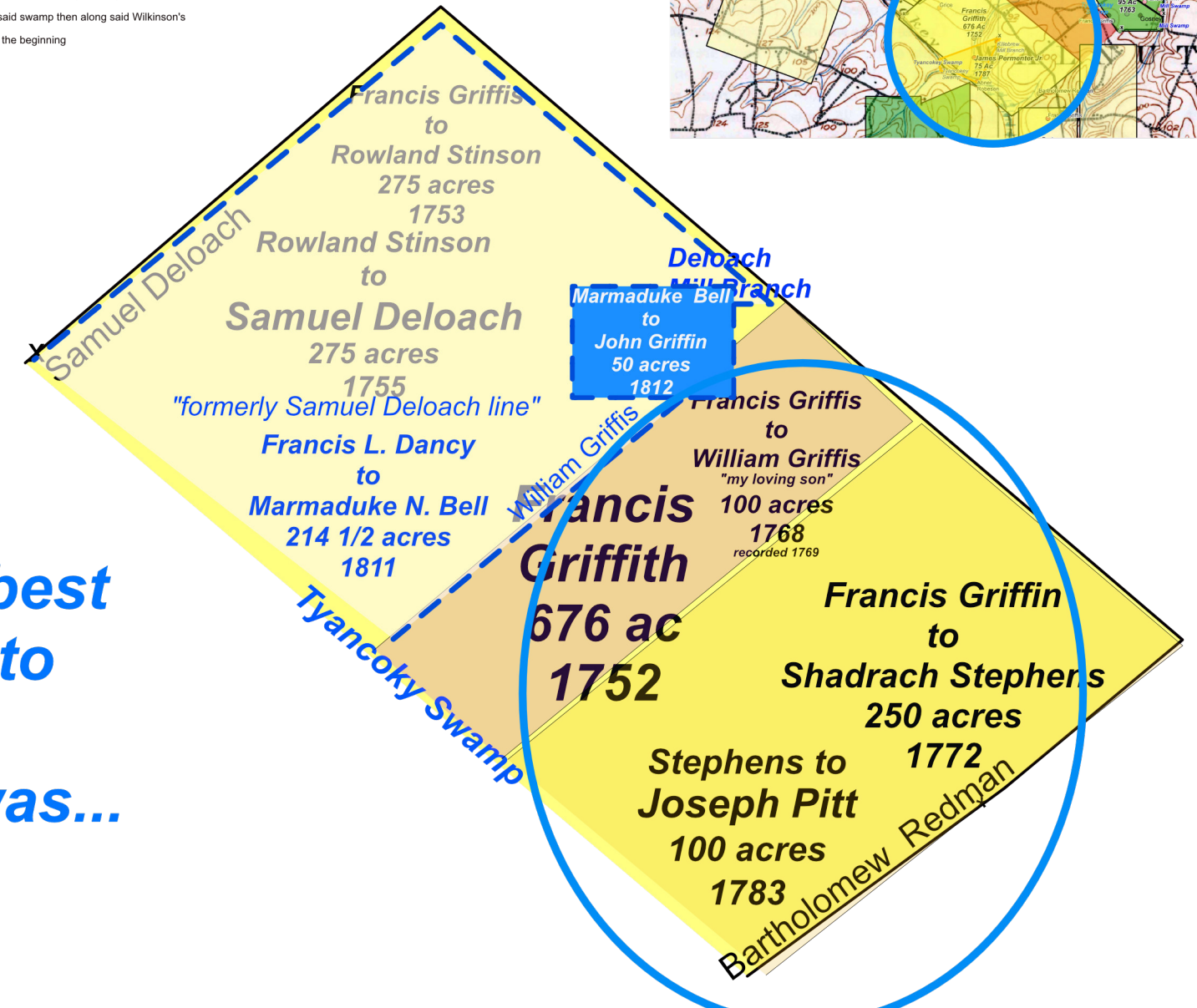
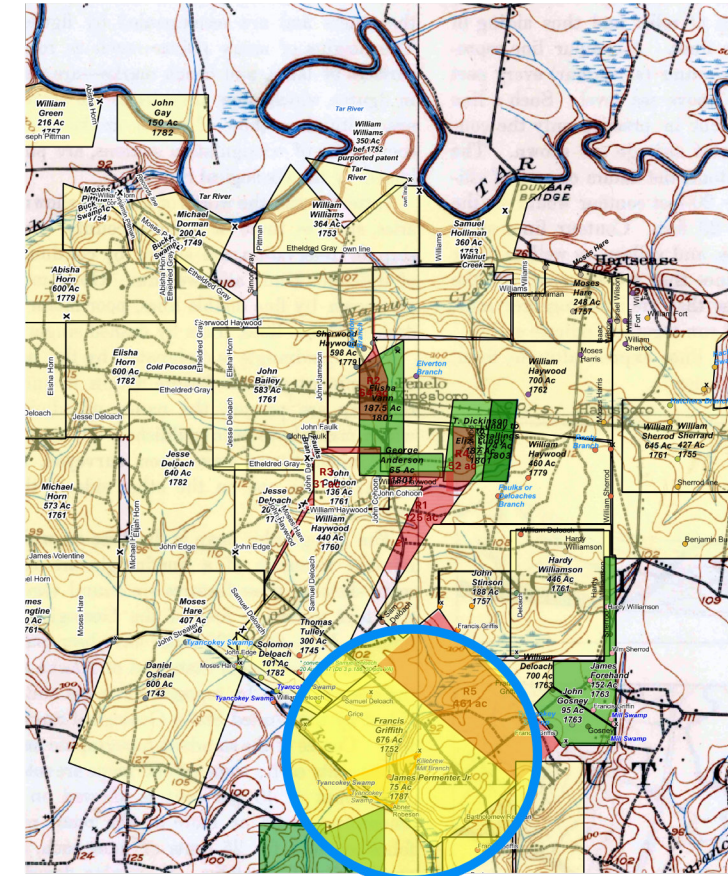
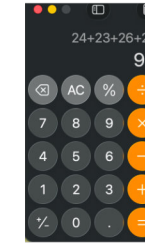

This is my best guess as to where Pitt's land was...

Edge. Co. Db 10, page 294, date of deed , date recorded , Shadrack Stephens, dec'd. to heirs, George Stephens and James Stephens, tract surveyed of 155 3/4 acres beginning at the mouth of a small branch that () into Tyan Cokey Swamp then up the various courses of said branch Stephen (Ponds) corner then along a line of marked trees to the dividing line between the said land of Stephen (Ponds) (three words) the following courses north about 35 east 20 poles north about 62 east 57 poles to a pine in Solomon Saunders' line then along his line south 42 east 104 poles to a pine Joseph Peles corner then along Peles line south 52 west 165 poles to a white oak Pele's other corner () a small branch then down the various courses of the branch to Tyan Cokey Swamp then up the () of the said swamp to the first station, Feb Ct. 1802, Starling Waller, (surveyor) between George Stephens and James Stephens, the lawful heirs; tract # 1 containing 77 acres, three rods and thirty poles, beginning at a water oak standing at the (run) of Tyan Cokey Swamp then along a line marked trees north (53 or 63) degrees (east) 265 poles to a stake in Solomon Saunders' line then along his line (south) (42 or 62) east 55 1/2 poles to a pine Joseph Peles corner then along his line south 52 west 165 poles to a white oak said (Pitts) other corner standing on a small branch then down the run of the courses of the said branch to the aforesaid Tyan Cokey Swamp then up the watery courses of said swamp to the first station, tract # 2 containing 77 acres, three rods and thirty poles beginning at the mouth of a small branch that empties into the aforesaid Tyan Cokey Swamp then up the various courses of the branch to a large pine standing on the side of the said branch Stephen Ponds corner then along a line of marked trees the dividing line of the above tract of land and Stephen Pond's land() the following courses north about 35 east (40) poles north 56 east 20 poles north about 62 east 57 poles to a pine in Solomon Saundser's line then along his line to a stake in said line the corner of no. one then along the line of no. one south 53 west 255 poles to a water oak standing in the run of the aforesaid mentioned swamp then up the various courses of the swamp to the first station. Abstracted 5 Apr. 01 FHC film 18887. CTC.